

MONTHLY STATUS REPORT

Date: February 5, 2016

GENERAL INFORMATION	
Reporting Month and Year: January 2016	Assigned TCEQ Coordinator: Trevor Andres
Facility Name: PSC – Plano Campus	
Facility Address: 2300 West Plano Parkway	
Facility City and State: Plano, Texas	County: Collin
Voluntary Cleanup Program (VCP) No.: 2480	SWR No.: 32109
Customer Reference No.: CN604033076	Regulated Entity No.: RN100663400
SUMMARY OF MONTHLY ACTIVITIES	
<p>Analytical results were received and reviewed in January 2016 for groundwater samples collected from nine (9) on-property and one (1) off-property Groundwater-Bearing Unit (GWBU) 1 monitoring wells; nine (9) on-property GWBU 2 monitoring wells and one (1) on-property GWBU3 monitoring well. As previously discussed in the December 2015 Status Report, PSC was unable to obtain a mutually acceptable access agreement for continued access to the adjoining Custer/Highway 190 Joint Venture (Custer) property for the resampling those monitoring wells installed by PSC in 2014. The COC analytical results for the above referenced monitoring wells are summarized on the attached Table 1. The locations of those monitoring wells sampled for COC analyses per the 2015 Supplemental Work Plan are show on the attached map, Figure 1.</p> <p>As indicated on attached Table 1, chloroform and 1,1-dichloroethene (1,1-DCE) were detected at GWBU 1 monitoring well MW-29 (off-property monitoring well on the south side of the President George Bush Turnpike) at concentrations below their protective concentration levels (PCLs). Tetrachloroethylene (PCE) and trichloroethylene (TCE) and associated daughter products were detected in on-property groundwater samples from GWBUs 1 and 2. Table 1 also shows that 1,1-DCE and vinyl chloride are the only COCs detected at concentrations exceeding the PCLs in groundwater from GWBU 3 collected from MW-1B. The applicable PCL for this assessment is the groundwater ingestion pathway (^{GW}GW_{ing}) for all COCs.</p>	
STATUS OF SUBMITTALS AND OUTSTANDING ISSUES	
<p>Notification of the availability of new analytical results for monitoring well MW-29 was submitted to the Texas Department of Transportation (TxDOT) via certified mail as of the date of this Status Report. An extension of the APAR due date to November 30, 2016 was granted by the TCEQ on December 2, 2015.</p>	
SUMMARY OF UPCOMING/PLANNED ACTIVITIES	
<p>In 2016, PSC plans to begin the process of acquiring a Municipal Setting Designation (MSD) ordinance from the City of Plano and a supporting MSD resolution from the City of Richardson prior to completing the APAR. Also in 2016, PSC intends to prepare and submit closure reports for the solid waste management units registered by a previous owner.</p>	

TABLE 1
DECEMBER 2015 GROUNDWATER SAMPLING RESULTS
VCP SITE NO. 2480
PLANO, TEXAS

Monitoring Well Number	Sample ID Name/Number	Sample Date	Sample Depth, Feet	Chemical of Concern (COC)									
				Arsenic, mg/L	Benzene, mg/L	Chloroform, mg/L	1,2-Dichloroethane, mg/L	1,1-Dichloroethane, mg/L	cis-1,2-Dichloroethylene, mg/L	Tetrachloroethylene, mg/L	1,1,2-Trichloroethane, mg/L	Trichloroethylene, mg/L	Vinyl Chloride, mg/L
MW-1	MW-1	12/21/2011	25	0.00696	0.0121	0.172D	0.0114	1.05D	0.0695	0.0122	<0.000410	0.0214	0.0273
	MW-1	9/13/2012		<0.0033	0.105	0.801	0.0418	8.47	0.974	0.374	0.0143	0.297	0.259
	MW-1	3/21/2013		0.239	0.00729	0.621D	0.0313	7.19D	0.567D	0.160JD	0.00878	0.202JD	0.0727
	MW-1	12/16/2015		0.0097J	0.0787	0.0502	0.0175	7.2D	0.730D	0.0685	0.00587	0.33D	1.88D
MW-1A	MW-1A	9/13/2012	36.5	<0.0033	0.019	0.00376J	0.00525	2.51	0.403	0.0336	0.00121J	0.0625	0.148
	MW-1A	3/21/2013		0.00832J	0.0142	0.00255J	0.00307J	2.34D	0.463D	0.0173	<0.000410	0.043	0.281D
	MW-1A	12/16/2015		0.0041J	0.0142	0.00521	0.00269J	1.57D	0.364D	0.021	0.00112J	0.05	0.504D
MW-1B	MW-1B	3/21/2013	49.5	<0.0033	0.00126J	<0.000206	0.000340J	0.059	0.00568	<0.000196	<0.000410	<0.000130	0.00198J
	MW-1B	12/16/2015		0.007J	0.00178J	<0.000107	<0.000283	0.067	0.00557	<0.000347	<0.000272	<0.000218	0.0108
MW-6	MW-6	9/12/2012	24	0.00820J	<0.00100	<0.00100	0.00310J	<0.00100	<0.00100	<0.00100	<0.00100	<0.00100	<0.00400
	MW-6	3/21/2013		0.00373J	<0.000097	<0.000206	<0.000900	<0.000330	<0.000350	<0.000196	<0.000410	<0.000130	<0.000310
	MW-6	12/16/2015		<0.0033	<0.000185	<0.000107	<0.000283	0.00024J	<0.000162	<0.000347	<0.000272	<0.000218	<0.000232
MW-6A	MW-6A	5/3/2013	37	SNC	0.00592	<0.00100	<0.00100	<0.00100	<0.00100	<0.00200	<0.00100	<0.00100	<0.00400
	MW-6A	8/28/2014		SNC	<0.001	<0.001	<0.001	<0.001	<0.001	<0.002	<0.001	0.00117J	<0.0004
	MW-6A	12/16/2015		<0.0033	<0.000185	<0.000107	<0.000283	<0.000178	<0.000162	<0.002	<0.001	<0.001	<0.0004
MW-8	MW-8	9/13/2012	26	<0.0033	0.00162J	0.00636	0.00272J	0.218X	0.0133	0.00366J	<0.00100	0.00423J	0.000670J
	MW-8	3/19/2013		<0.0033	<0.000097	0.00524	0.00186J	0.148	0.000660J	0.00193J	<0.000410	0.00237J	<0.000310
	MW-8	12/16/2015		0.0119	<0.001	0.00221JX	0.00251J	0.485D	0.0147	0.00299J	<0.001	0.00437J	<0.0004
MW-8A	MW-8A	3/19/2013	38	0.0115	0.000100J	<0.000206	<0.000900	0.000830J	<0.000350	0.00193J	<0.000410	<0.000130	<0.000310
	MW-8A	12/16/2015		<0.0033	<0.001	<0.001	<0.001	<0.001	<0.001	<0.002	<0.001	<0.001	<0.0004
MW-10	MW-10	10/5/2012	21.5	SNC	<0.00100	0.00612	<0.00100	0.0114	<0.00100	<0.00100	<0.00100	<0.00100	<0.00400
	MW-10	3/22/2013		<0.0033	<0.000097	0.0191	0.00108J	0.0397	<0.000350	0.000580J	<0.000410	<0.000130	<0.000310
	MW-10	3/22/2013		0.0104	<0.000097	0.0189	0.00110J	0.0369	<0.000350	0.000740J	<0.000410	<0.000130	<0.000310
	MW-10	8/28/2014		SNC	<0.001	0.0159	0.00128J	0.0558	<0.001	<0.002	<0.001	<0.001	<0.0004
MW-13	MW-13	3/18/2013	16	<0.0033	<0.000970	<0.000206	<0.000900	<0.000330	<0.000350	0.000320J	<0.000410	<0.000130	<0.000310
	MW-13	3/18/2013		0.00538J	<0.000970	0.000560J	<0.000900	0.00302J	<0.000350	<0.000196	<0.000410	<0.000130	<0.000310
	MW-13	12/16/2015		0.0066J	<0.001	<0.001	<0.001	<0.001	<0.001	<0.002	<0.001	<0.001	<0.0004
MW-13A	MW-13A	3/18/2013	28.5	<0.0033	0.000190J	<0.000206	<0.000900	<0.000330	<0.000350	<0.000196	<0.000410	<0.000130	<0.000310
	MW-13A	12/16/2015		<0.0033	<0.001	<0.001	<0.001	<0.001	<0.001	<0.002	<0.001	<0.001	<0.0004
MW-14	MW-14	5/3/2013	15.5	<0.0033	<0.00100	<0.00100	<0.00100	0.0212	<0.00100	<0.00200	<0.00100	<0.00100	<0.00400
	MW-14	8/28/2014		SNC	<0.001	0.00117J	<0.001	0.00123J	<0.001	<0.002	<0.001	<0.001	<0.0004
	MW-14	12/16/2015		<0.0033	<0.001	<0.001	<0.001	0.00241J	<0.001	<0.002	<0.001	<0.001	<0.0004
MW-14A	MW-14A	3/22/2013	22.5	0.0105J	<0.000970	<0.000206	<0.000900	<0.000330	<0.000350	<0.000196	<0.000410	<0.000130	<0.000310
	MW-14A	12/16/2015		<0.0033	<0.001	<0.001	<0.001	<0.001	<0.001	<0.002	<0.001	<0.001	<0.0004
MW-15A	MW-15A	3/22/2013	38.5	<0.0033	<0.000097	<0.000206	<0.000900	<0.000330	<0.000350	<0.000196	<0.000410	<0.000130	<0.000310
	MW-15A	3/22/2013		<0.0033	<0.000097	<0.000206	<0.000900	<0.000330	<0.000350	<0.000196	<0.000410	<0.000130	<0.000310
	MW-15A	12/16/2015		<0.0033	<0.000185	<0.000107	<0.000283	0.00061J	<0.000162	<0.000347	<0.000272	<0.000218	<0.000232
MW-18	MW-18	3/21/2013	24.5	0.00874J	0.00518	0.134	0.0142	2.60DX	0.613DX	0.368DX	<0.00041	0.143D	<0.00031
	MW-18	12/16/2015		<0.0033	0.0194	0.143	0.0112	3.63D	4.95D	1.72D	0.00505	0.984D	0.915
MW-18A	MW-18A	3/21/2013	38	<0.0033	0.00111J	0.00138J	0.00445J	2.03D	0.301D	0.0426	<0.00041	0.0447	0.0258
	MW-18A	12/16/2015		<0.0033	0.00263J	0.00036J	0.00261J	0.814D	0.124	0.0188	0.00043J	0.0268	0.0474
MW-20	MW-20	3/22/2013	29.5	SNC	0.000180J	0.000530J	<0.000900	0.00956	0.00109J	<0.000196	<0.000410	<0.000130	<0.000310
	MW-20	8/28/2014		SNC	<0.001	<0.001	<0.001	0.0077	<0.001	<0.002	<0.001	<0.001	<0.0004
	MW-20	12/22/2015		0.0045J	<0.001	<0.001	<0.001	<0.001	<0.001	<0.002	<0.001	<0.001	<0.0004
MW-20A	MW-20A	3/22/2013	34.5	<0.0033	0.000180J	0.000360J	<0.000900	<0.000330	<0.000350	<0.000196	<0.000410	<0.000130	<0.000310
	MW-20A	12/22/2015		0.0035J	<0.001	<0.001	<0.001	<0.001	<0.001	<0.002	<0.001	<0.001	<0.0004
MW-21	MW-21	3/21/2013	23.5	0.00376J	<0.000970	0.000230J	0.000470J	0.0473	<0.000350	<0.000196	<0.000410	<0.000130	0.00811
	MW-21	8/28/2014		SNC	<0.001	<0.001	<0.001	0.0283	<0.001	<0.002	<0.001	<0.001	<0.0004
	MW-21	12/16/2015		<0.0033	<0.000185	<0.000107	<0.000283	0.0155	<0.000162	<0.000347	<0.000272	<0.000218	<0.000232
MW-21A	MW-21A	3/21/2013	37.5	<0.0033	0.00274J	0.00119J	0.00142J	0.584D	0.0557	0.00404J	<0.000410	0.00781	0.0362
	MW-21A	3/21/2013		<0.0033	0.00318J	0.00101J	0.00156J	0.456	0.0609	0.00621	<0.000410	0.00933	0.0387
	MW-21A	9/4/2014		SNC	0.00187J	<0.001	0.0016J	0.778D	0.0383	0.00696	<0.001	0.00921	0.0373
	MW-21A	12/16/2015		0.0035J	0.00446J	0.00037J	0.00231J	1.07D	0.0796	0.014	<0.000272	0.0194	0.0781
MW-29	MW-29	8/27/2014	15	SNC	<0.001	0.00154J	<0.001	0.00272J	<0.001	<0.002	<0.001	<0.001	<0.0004
	MW-29	12/16/2015		<0.0033	<0.000185	0.0011J	<0.000283	0.0007J	<0.000162	<0.000347	<0.000272	<0.000218	<0.000232
Tier 1 Residential Assessment Level				0.01	0.005	0.24	0.005	0.007	0.07	0.005	0.005	0.005	0.002
Critical PCLs				0.01	0.005	0.24	0.005	0.007	0.07	0.005	0.005	0.005	0.002

Notes

- Red highlighted cell or font exceeds the assessment level for Class 1 and Class 2 groundwater.
- All critical PCLs, which the exception of silver are based on Federal Maximum Concentration Levels for drinking water.
- SNC - Sample Not Collected
- NA - Not analyzed
- NR - Not reported
- D - Dilution due to analytes detected over the highest point of the calibration curve, or due to matrix interference
- X - MS/MSD recoveries were found to be outside of the laboratory control limits due to possible matrix

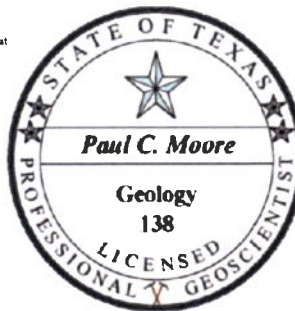

02/05/2016

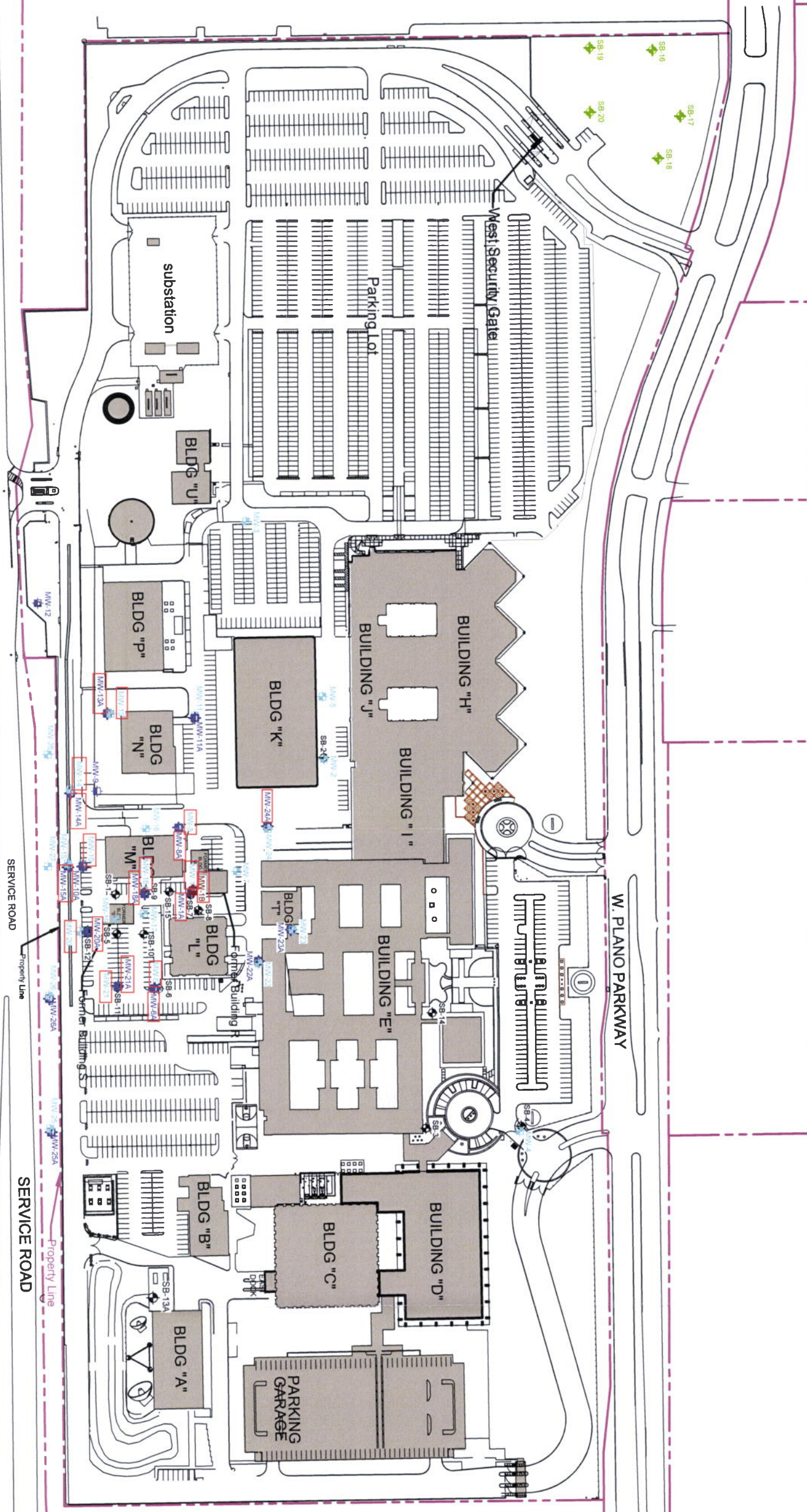

Custer/Highway 190
Joint Venture

S.H. 190 PRESIDENT GEORGE BUSH TURNPIKE

S.H. 190 PRESIDENT GEORGE BUSH TURNPIKE

W. PLANO PARKWAY

WEST BOUND LANES

EAST BOUND LANES

SERVICE ROAD

SERVICE ROAD

Legend:

- GWBU 1 Monitoring Well
- GWBU 2 Monitoring Well
- GWBU 3 Monitoring Well
- COC Soil Boring
- Background Soil Boring

Base Map: CAD Drawing provided by Dell Inc.
Property Boundaries: Collin County Appraisal District Interactive Map Accessed on January 14, 2013.
Note: Buildings designation is by single letter, for example Building "N".



<p>PSC Management Limited Partnership 2300 West Plano Parkway Plano, Texas</p>		<p>FIGURE 1 EXISTING MONITORING WELL AND SOIL BORING LOCATIONS</p>	
	<p>Designed By: P.C. Moore</p>	<p>Checked By: D. Sorrells</p>	<p>Project No. 013330</p>
	<p>Date: 07/24/2015</p>		<p>Sheet: 1 of 1</p>